

## Swivel Clamp Connectors

### Aluminum

#### SPECIFICATION

##### Types

- Type **OZ**: Without centering step (smooth)
- Type **MZ**: With centering step
- Type **AV**: With external serration
- Type **IV**: With internal serration

##### Aluminum

- Powder coated  
Black, RAL 9005, textured finish **SW**
- Plain, matte shot-blasted **BL**

Socket cap screws DIN 912

Stainless Steel AISI 304

Hex nuts DIN 985

Stainless Steel AISI 304

Self-locking via polyamide ring



#### INFORMATION

The clamping bore of swivel clamp connectors GN 274 is mechanically machined and designed for construction tubes GN 990 (see page 1902) or DIN 2391, DIN 2395 and DIN 2462.

At the screw location **z**, the socket cap screw reduces the bore cross-section for clamping. For clamping without tools, the socket cap screw can be replaced by an adjustable hand lever GN 911 (see page 1874) listed in the table as accessory.

Swivel clamp connectors GN 274 can be combined with swivel clamp connectors GN 272 (see page 1848), GN 276 (see page 1852) or GN 278 (see page 1856) to swivel clamp connector joints.

#### ACCESSORY

- Adjustable Hand Levers GN 911 (see page 1874)

#### TECHNICAL INFORMATION

- Stainless Steel Characteristics (see page A26)

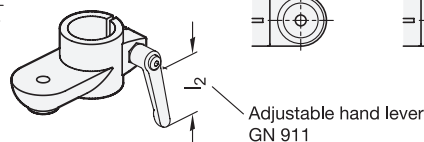
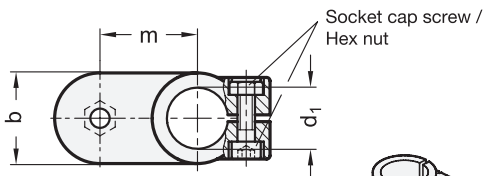
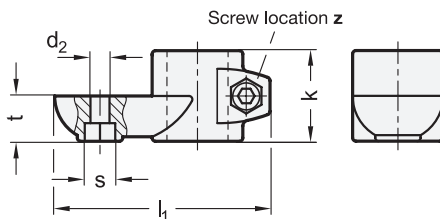

Type **OZ**



Type **AV**

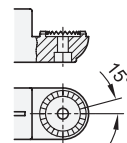

Type **MZ**

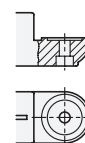

Type **IV**

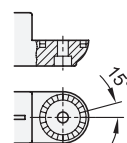

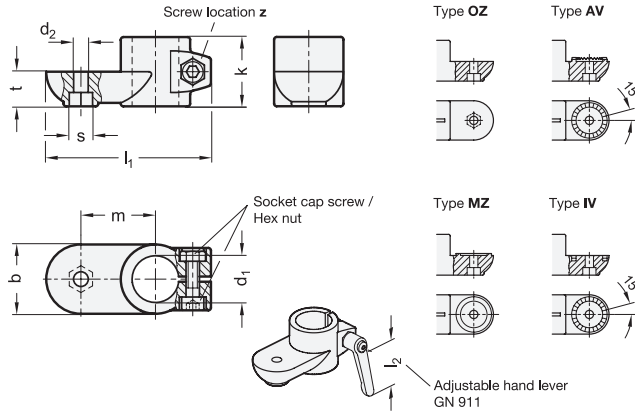

\* Complete with  
SW BL  
 RAL9005 Plain

### GN 274-OZ

Description	d1 Bore	b	d2	k	li	m	s	t	z Screw location	Accessory Recom. hand lever GN 911 for z lz	⚖️
GN 274-B20-OZ-2-*	B 20	40	8.5	40	95	43	13	20	M8-25	-	190
GN 274-B25-OZ-2-*	B 25	40	8.5	40	95	43	13	20	M8-25	63   78	167
GN 274-B30-OZ-2-*	B 30	40	8.5	40	95	43	13	20	M8-25	63   78	150
GN 274-B40-OZ-2-*	B 40	65	10.5	65	148	70	17	32.5	M10-50	-	710
GN 274-B42-OZ-2-*	B 42	65	10.5	65	148	70	17	32.5	M10-50	-	685
GN 274-B45-OZ-2-*	B 45	65	10.5	65	148	70	17	32.5	M10-50	78   92	650
GN 274-B48-OZ-2-*	B 48	65	10.5	65	148	70	17	32.5	M10-50	78   92	610
GN 274-B50-OZ-2-*	B 50	65	10.5	65	148	70	17	32.5	M10-50	78   92	585

### GN 274-MZ

Description	d1 Bore	b	d2	k	li	m	s	t	z Screw location	Accessory Recom. hand lever GN 911 for z lz	⚖️
GN 274-B20-MZ-2-*	B 20	40	8.5	40	95	43	13	20	M8-25	-	190
GN 274-B25-MZ-2-*	B 25	40	8.5	40	95	43	13	20	M8-25	63   78	170
GN 274-B30-MZ-2-*	B 30	40	8.5	40	95	43	13	20	M8-25	63   78	150
GN 274-B40-MZ-2-*	B 40	65	10.5	65	148	70	17	32.5	M10-50	-	700
GN 274-B42-MZ-2-*	B 42	65	10.5	65	148	70	17	32.5	M10-50	-	690
GN 274-B45-MZ-2-*	B 45	65	10.5	65	148	70	17	32.5	M10-50	78   92	655
GN 274-B48-MZ-2-*	B 48	65	10.5	65	148	70	17	32.5	M10-50	78   92	615
GN 274-B50-MZ-2-*	B 50	65	10.5	65	148	70	17	32.5	M10-50	78   92	585

### GN 274-AV

Description	d1 Bore	b	d2	k	li	m	s	t	z Screw location	Accessory Recom. hand lever GN 911 for z lz	⚖️
GN 274-B20-AV-2-*	B 20	40	8.5	40	95	43	13	20	M8-25	-	185
GN 274-B25-AV-2-*	B 25	40	8.5	40	95	43	13	20	M8-25	63   78	170
GN 274-B30-AV-2-*	B 30	40	8.5	40	95	43	13	20	M8-25	63   78	150
GN 274-B40-AV-2-*	B 40	65	10.5	65	148	70	17	32.5	M10-50	-	710
GN 274-B42-AV-2-*	B 42	65	10.5	65	148	70	17	32.5	M10-50	-	690
GN 274-B45-AV-2-*	B 45	65	10.5	65	148	70	17	32.5	M10-50	78   92	655
GN 274-B48-AV-2-*	B 48	65	10.5	65	148	70	17	32.5	M10-50	78   92	620
GN 274-B50-AV-2-*	B 50	65	10.5	65	148	70	17	32.5	M10-50	78   92	585

### GN 274-IV

Description	d1 Bore	b	d2	k	li	m	s	t	z Screw location	Accessory Recom. hand lever GN 911 for z lz	⚖️
GN 274-B20-IV-2-*	B 20	40	8.5	40	95	43	13	20	M8-25	-	180
GN 274-B25-IV-2-*	B 25	40	8.5	40	95	43	13	20	M8-25	63   78	160
GN 274-B30-IV-2-*	B 30	40	8.5	40	95	43	13	20	M8-25	63   78	140
GN 274-B40-IV-2-*	B 40	65	10.5	65	148	70	17	32.5	M10-50	-	690
GN 274-B42-IV-2-*	B 42	65	10.5	65	148	70	17	32.5	M10-50	-	665
GN 274-B45-IV-2-*	B 45	65	10.5	65	148	70	17	32.5	M10-50	78   92	635
GN 274-B48-IV-2-*	B 48	65	10.5	65	148	70	17	32.5	M10-50	78   92	600
GN 274-B50-IV-2-*	B 50	65	10.5	65	148	70	17	32.5	M10-50	78   92	570

Weight SW

